

BRAVO SNORKEL



VOLKSWAGEN CRAFTER / MAN TGE

VARIANT: (2017 - On.)

REF: **SVCR**

FITMENT SIDE: **Right**

LINEAR LOW DENSITY POLYETHYLENE RESINE



LL 8446 is a linear low density butene copolymer designed to offer excellent processability, whiteness, and fast grinding rate. This UV stabilized resin is ideally suited for applications that require excellent dimensional control and low warpage.

PROPERTIES

Additive

Long Term UV-8 Stabilizer

Density

0.936 g/cm³ (Based on ISO 1183)

Melt Index (190°/2.16 Kg)

5.0 g/10min (Based on ISO 1183)

PART	DESCRIPTION	QTY
1	Snorkel body	x1
2	Snorkel head 89 mm / 3,5"	x1
3	Black clamp 78 - 101 mm	x1
4	Bracket upper mounting	x1
5	Rivet 4,8 x 10 mm	x3
6	Allen bolt M6 x 12 mm	x2
7	Rubber washer M5 x 14 mm	x3
8	Allen screw M6 x 30 mm	x2
9	Washer M6 x 20 mm	x2
10	Fender template	x1
11	Rivnut M6 x 14 mm	x2
12	Rubber duct connecting	x1

PART	DESCRIPTION	QTY
13	PE duct connecting	x1
14	Clamp 90 - 110 mm	x2
15	Metal bracket	x1
16	Washer M6 x 14 mm	x1
17	Nut -nyloc M6 x 10 mm	x1
18	SEMS bolt M6 x 14 mm	x1
19	Screw M4 x 12 mm	x1

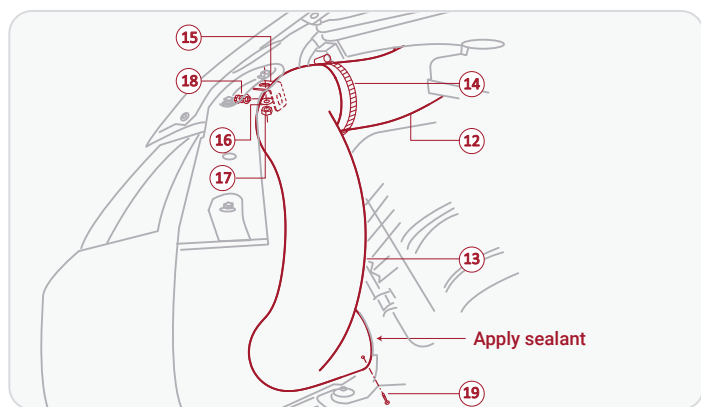
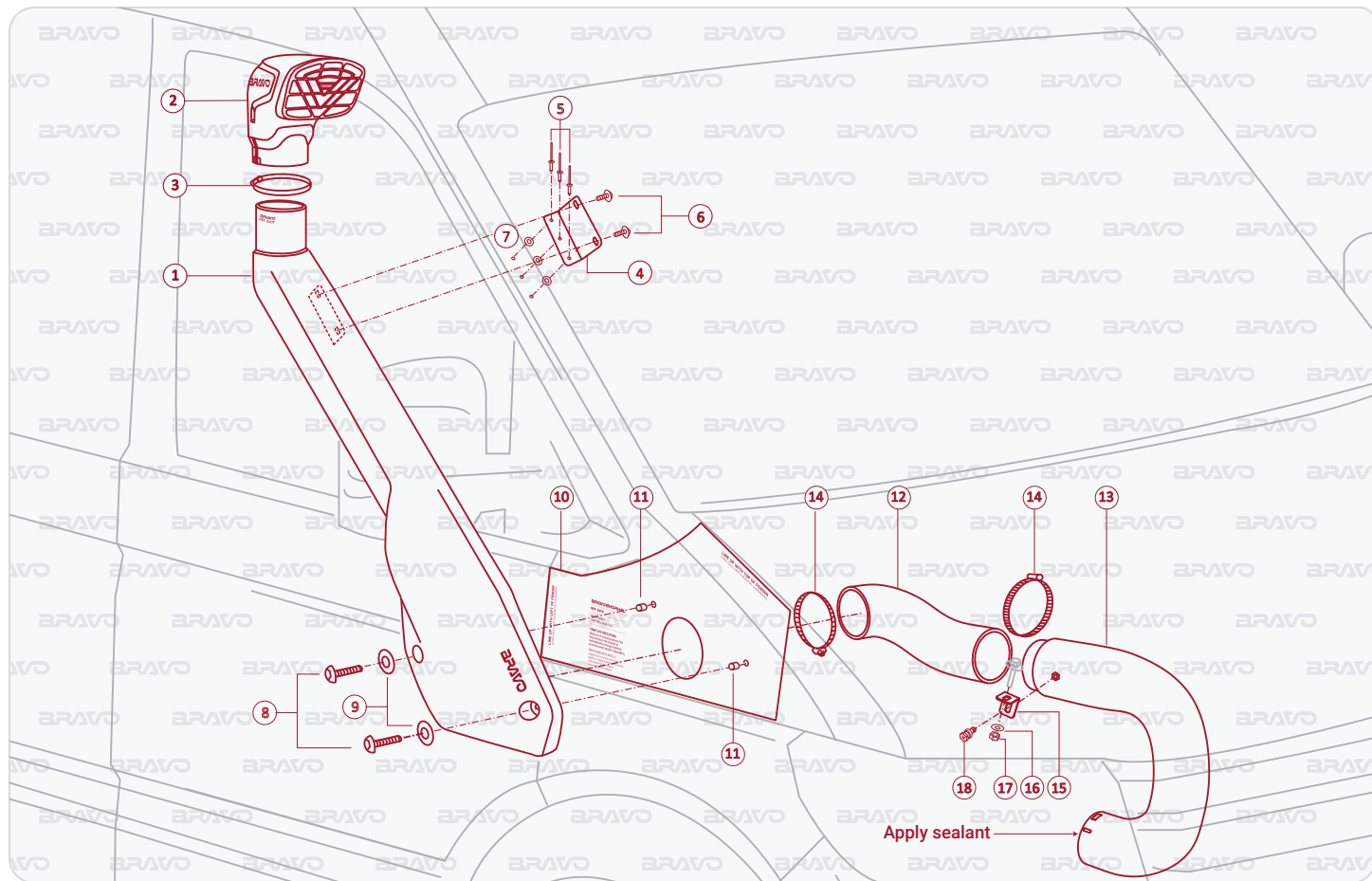

Installation process is under installer's responsibility.